

Product: TRACK-TYPE TRACTOR

Model: D8T TRACK-TYPE TRACTOR MLN

Configuration: D8T TRACK-TYPE TRACTOR MLN00001-UP (MACHINE) POWERED BY C15 Engine

## Disassembly and Assembly C15 and C18 Engines for Caterpillar Built Machines

Media Number -KENR8151-04

Publication Date -01/07/2014

Date Updated -01/07/2014

i02187181

# Power Take-Off Drive Group - Assemble

SMCS - 1165-016

## Assembly Procedure

Table 1

Required Tools			
Tool	Part Number	Part Description	Qty
A	-	Guide Stud (5/8 - 18 x 8 inch)	2
B	1P-0520	Driver Group	2
C	9S-3263	Thread Lock Compound	-

---

### NOTICE

**Keep all parts clean from contaminants.**

**Contaminants may cause rapid wear and shortened component life.**

---

---

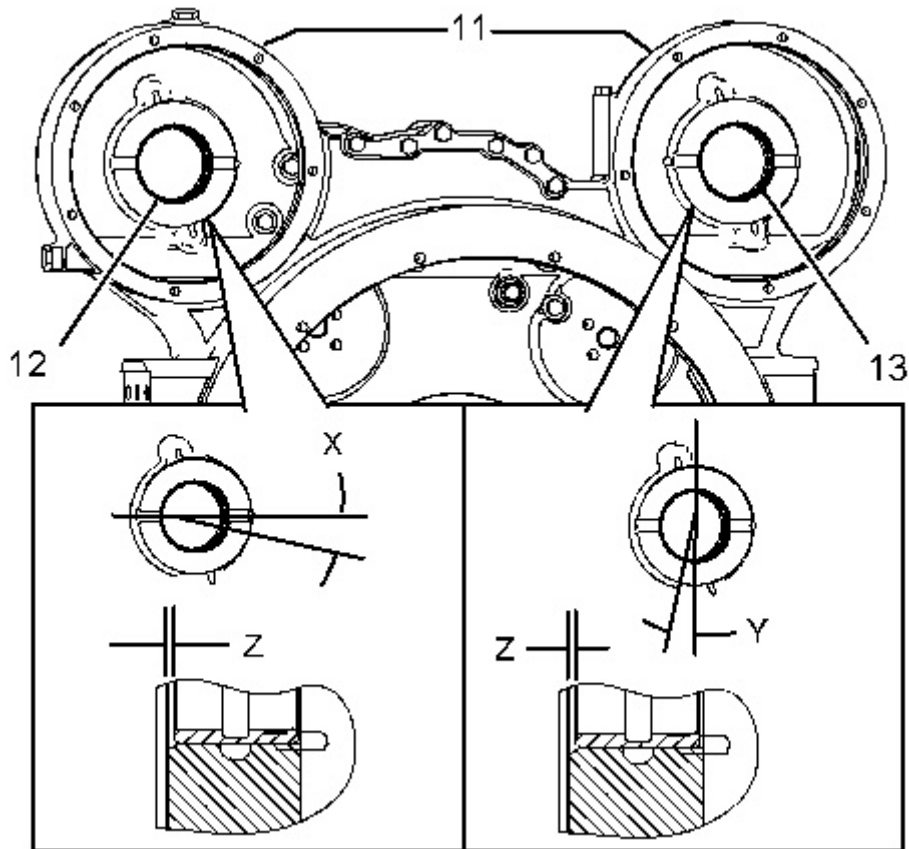

---

Illustration 1

g01106888

1. Install sleeve bearing (13) in the flywheel housing with Tooling (B). The split in the sleeve bearing should be located at Angle (Y), which is  $15 \pm 1$  degrees from the horizontal centerline. The bearing should be installed to Depth (Z), which is  $2.0 \pm 0.5$  mm ( $0.08 \pm 0.02$  inch).
  2. Install sleeve bearing (12) in the flywheel housing with Tooling (B). The split in the sleeve bearing should be located at Angle (X), which is  $15 \pm 1$  degrees from the vertical centerline. The bearing should be installed to Depth (Z), which is  $2.0 \pm 0.5$  mm ( $0.08 \pm 0.02$  inch).
  3. Install the O-ring seal on cover (11). Install cover (11) and the bolts on the back side of the flywheel housing.
-

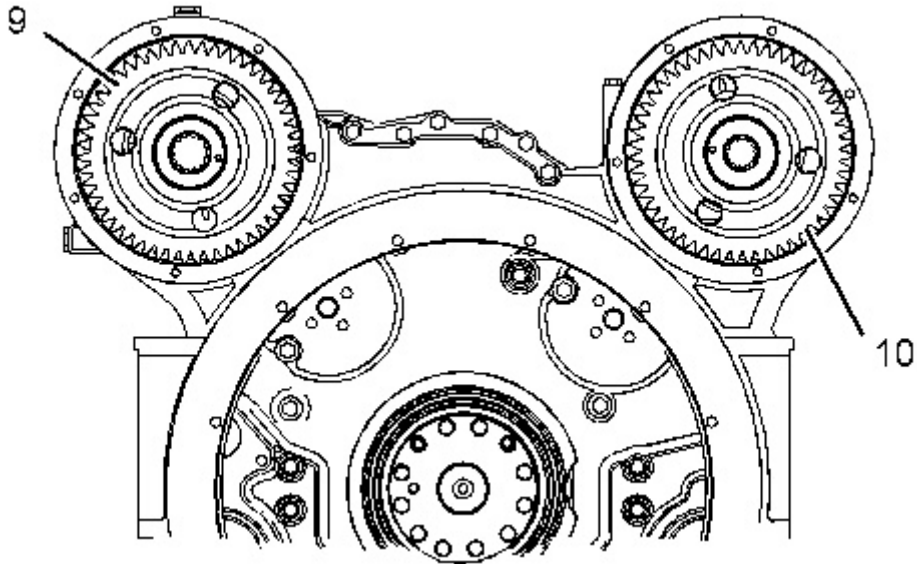

---

Illustration 2

g01106649

4. Position gear assembly (9) and gear assembly (10) in the flywheel housing.
- 

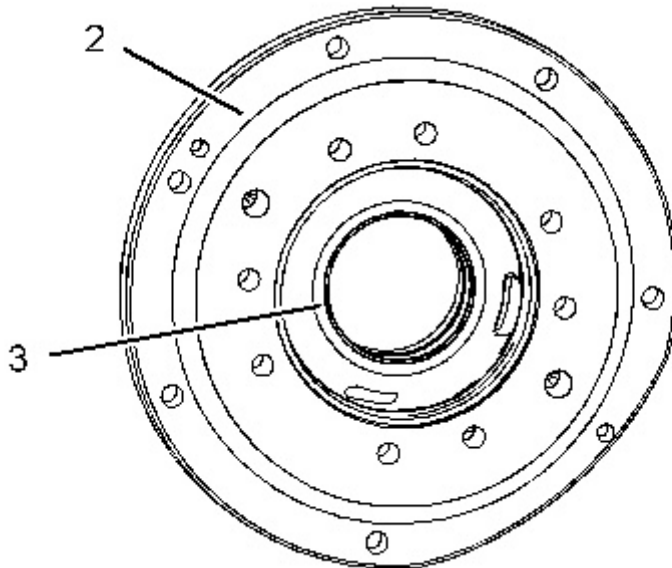

---

Illustration 3

g01106948

5. Use Tooling (B) and install sleeve bearing (3) in adapter (2). Install the O-ring seal on adapter (2).
-

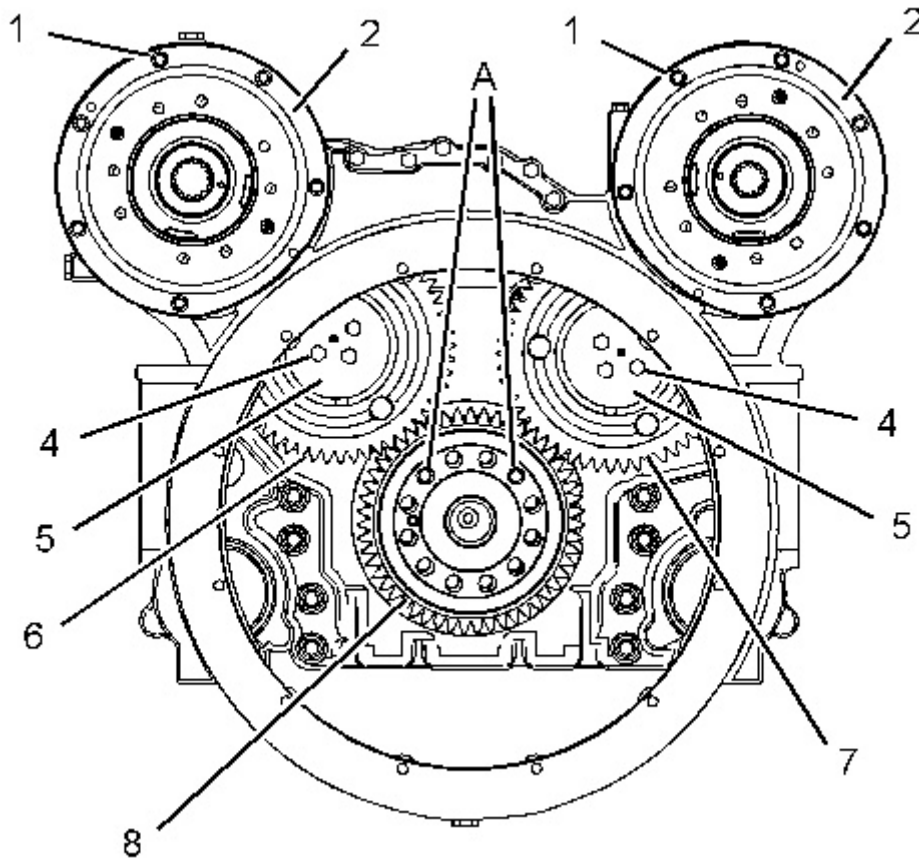

---

Illustration 4

g01106976

6. Align the relief groove in the sleeve bearing with the relief groove in the idler gear (6). Use Tooling (B) to install the sleeve bearing in idler gear (6).
7. Position idler gear (6) and retainer (5). Install bolts (4).
8. Align the relief groove in the sleeve bearing with the relief groove in the idler gear (7). Use Tooling (B) to install the sleeve bearing in idler gear (7).
9. Position idler gear (7) and retainer (5). Install bolts (4).
10. Install the O-ring seal in the counterbore of crankshaft gear (8). Lubricate the O-ring seal with clean engine oil. Install crankshaft gear (8) on Tooling (A).
11. Position adapter (2) on the flywheel housing. Apply Tooling (C) to the threads of bolts (1) and install the bolts.

**End By:**

- a. Install the flywheel. Refer to Disassembly and Assembly, "Flywheel - Install".
-

Product: TRACK-TYPE TRACTOR

Model: D8T TRACK-TYPE TRACTOR MLN

Configuration: D8T TRACK-TYPE TRACTOR MLN00001-UP (MACHINE) POWERED BY C15 Engine

## Disassembly and Assembly C15 and C18 Engines for Caterpillar Built Machines

Media Number -KENR8151-04

Publication Date -01/07/2014

Date Updated -01/07/2014

i04557373

# Vibration Damper and Pulley - Remove and Install

SMCS - 1205-010

## Removal Procedure

Table 1

Required Tools			
Tool	Part Number	Part Description	Qty
A	-	Guide Bolt 5/8 - 18 NF by 7 inch	1
B	4C-5593	Thread Lubricant	-

---

### NOTICE

**Keep all parts clean from contaminants.**

**Contaminants may cause rapid wear and shortened component life.**

---

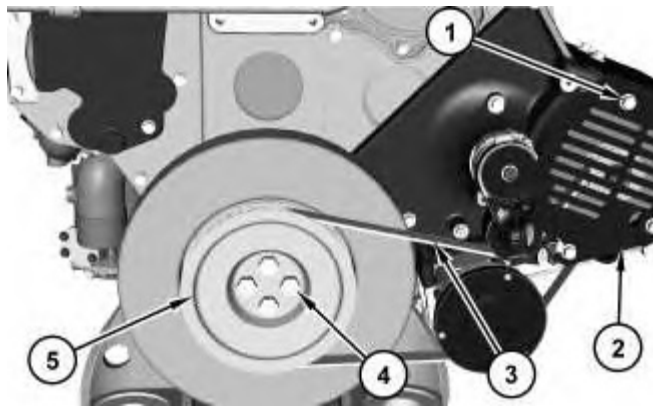

---

Illustration 1

g02160891

1. Remove bolts (1) and remove guard (2) .
2. Release the tension on the belt tensioner in order to position belt (3) out of the way.
3. Remove bolts (4) and remove pulley (5) .

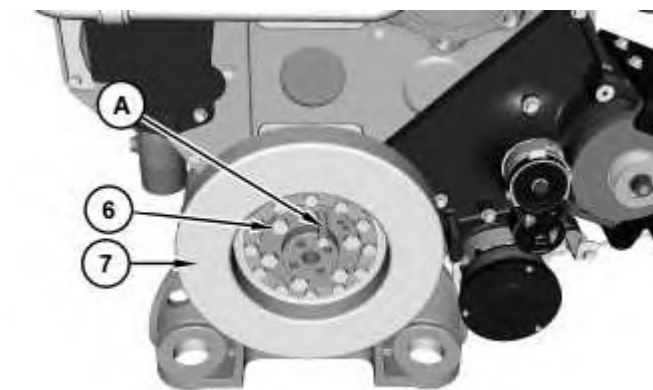

---

Illustration 2

g02160924

4. Remove one bolt (6) and install Tooling (A) .
  5. Remove remaining bolts (6) . Use two people in order to remove vibration damper assembly (7) . The weight of vibration damper assembly (2) is approximately 46 kg (100 lb).
-

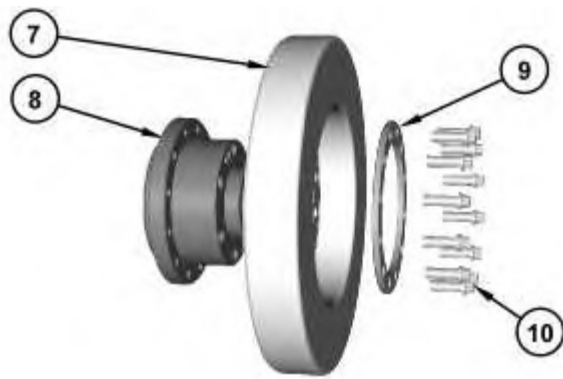

---

Illustration 3

g02161096

6. Remove bolts (10) and remove spacer (9) .
7. Separate damper (7) from adapter (8) .

## Installation Procedure

1. Install vibration damper (7) in the reverse order.
    - a. Apply Tooling (B) to bolts (6) .
    - b. Tighten bolts (6) to a torque of  $270 \pm 40$  N·m ( $200 \pm 30$  lb ft).
-

Product: TRACK-TYPE TRACTOR

Model: D8T TRACK-TYPE TRACTOR MLN

Configuration: D8T TRACK-TYPE TRACTOR MLN00001-UP (MACHINE) POWERED BY C15 Engine

## Disassembly and Assembly C15 and C18 Engines for Caterpillar Built Machines

Media Number -KENR8151-04

Publication Date -01/07/2014

Date Updated -01/07/2014

i02507762

# Crankshaft Front Seal - Remove

SMCS - 1160-011

## Removal Procedure

Table 1

Required Tools			
Tool	Part Number	Part Description	Qty
A	1U-7600	Slide Hammer Puller	1

### Start By:

- Remove the vibration damper and the pulley. Refer to Disassembly and Assembly, "Vibration Damper and Pulley - Remove and Install".

---

### NOTICE

**Keep all parts clean from contaminants.**

**Contaminants may cause rapid wear and shortened component life.**

---

---



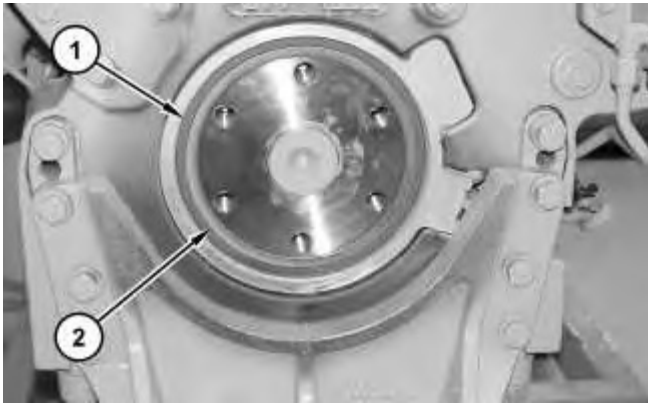

---

Illustration 1

g01255652

1. If necessary, use Tooling (A) or a punch and hammer in order to puncture three or more holes in wear sleeve (1).
  2. If necessary, use Tooling (A) in order to remove wear sleeve (1).
  3. Use Tooling (A) or a punch and hammer in order to puncture three or more holes in crankshaft front seal (2).
  4. Use Tooling (A) in order to remove crankshaft front seal (2).
-



**Download the full PDF manual instantly.**

**Our customer service e-mail:**

**[aservicemanualpdf@yahoo.com](mailto:aservicemanualpdf@yahoo.com)**