PROPEL SPEED RANGE SWITCH REPLACEMENT

0074 00

THIS WORK PACKAGE COVERS

Removal, Installation

INITIAL SETUP**Tools and Special Tools**

Tool kit, general mechanic's (Item 36, WP 0220 00)

Materials/Parts

Lockwasher (3)

References

TM 5-3895-379-23P, Figure 4

Equipment Condition

Engine off (TM 5-3895-379-10)

Drums chocked (TM 5-3895-379-10)

Battery disconnect switch in OFF position (TM 5-3895-379-10)

Right-side door assembly opened (TM 5-3895-379-10)

REMOVAL

1. Remove two screws (1) and washers (2) from operator station (3).
2. Remove seven screws (1) and washers (4) from operator station (3).
3. Lift panel assembly (5) and pull away from operator station (3).

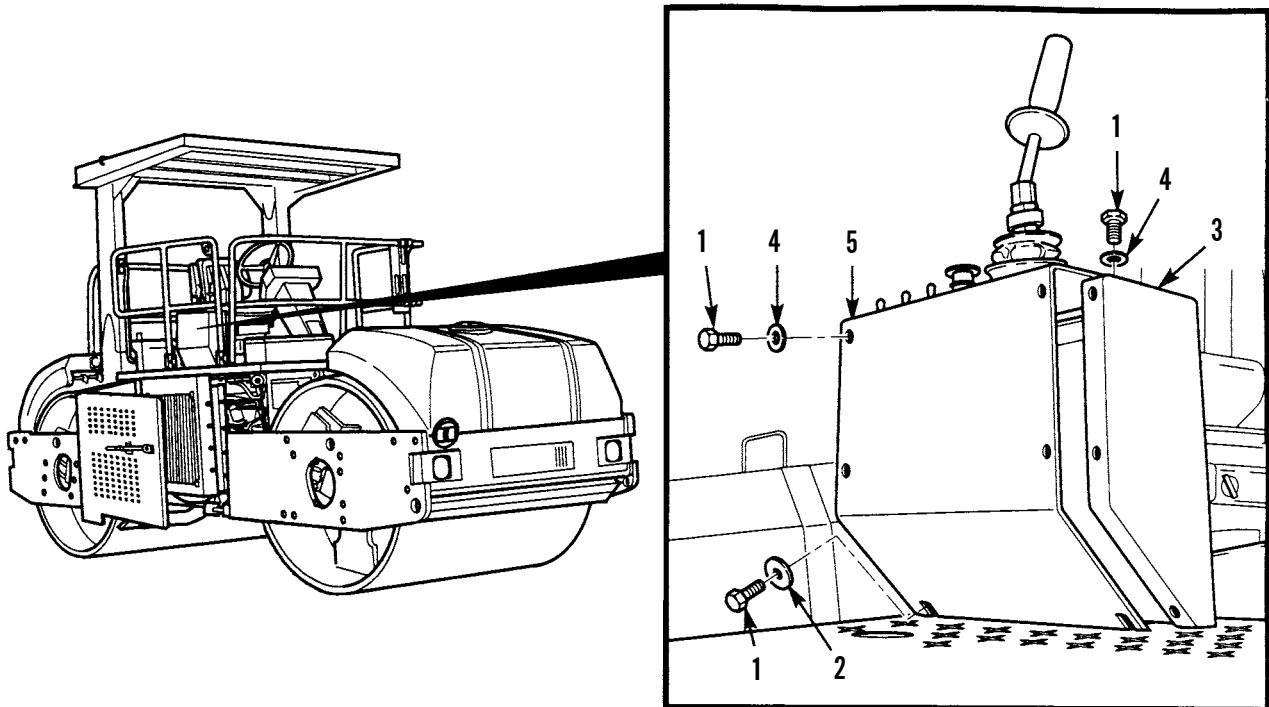

401-446

PROPEL SPEED RANGE SWITCH REPLACEMENT - CONTINUED**0074 00****REMOVAL - CONTINUED**

4. Remove nut (6), lockwasher (7), propel speed range switch (8) and ring (9) from panel assembly (5). Discard lockwasher.

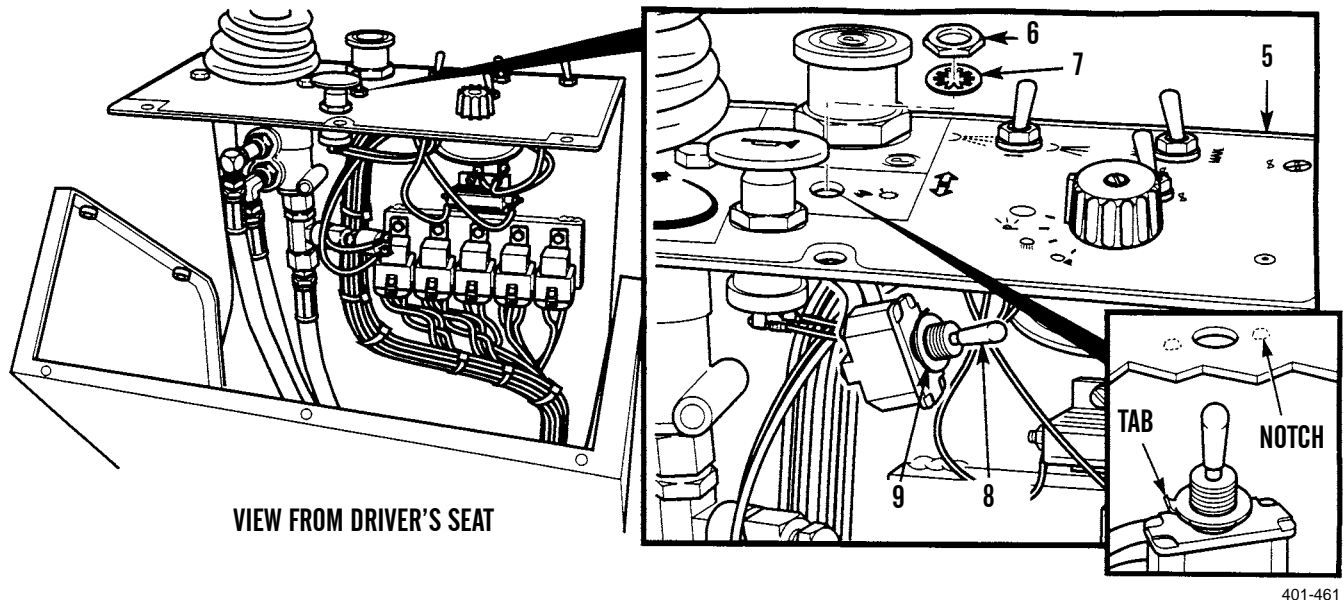
**NOTE**

Tag and mark all wires prior to removal.

5. Remove two screws (10), lockwashers (11) and wires (12) and (13) from propel speed range switch (8). Discard lockwashers.

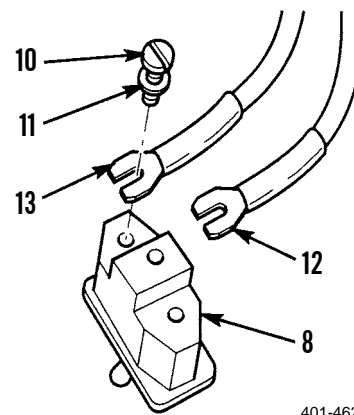
**INSTALLATION**

1. Install two wires (12) and (13) on propel speed range switch (8) with new lockwashers (11) and screws (10).

NOTE

Tab of ring fits in notch of panel assembly to properly align propel speed range switch in panel assembly.

2. Install propel speed range switch (8) on panel assembly (5) with ring (9), new lockwasher (7) and nut (6).

PROPEL SPEED RANGE SWITCH REPLACEMENT - CONTINUED**0074 00****INSTALLATION - CONTINUED**

3. Install panel assembly (5) on operator station (3) with two washers (2), seven washers (4) and nine screws (1).

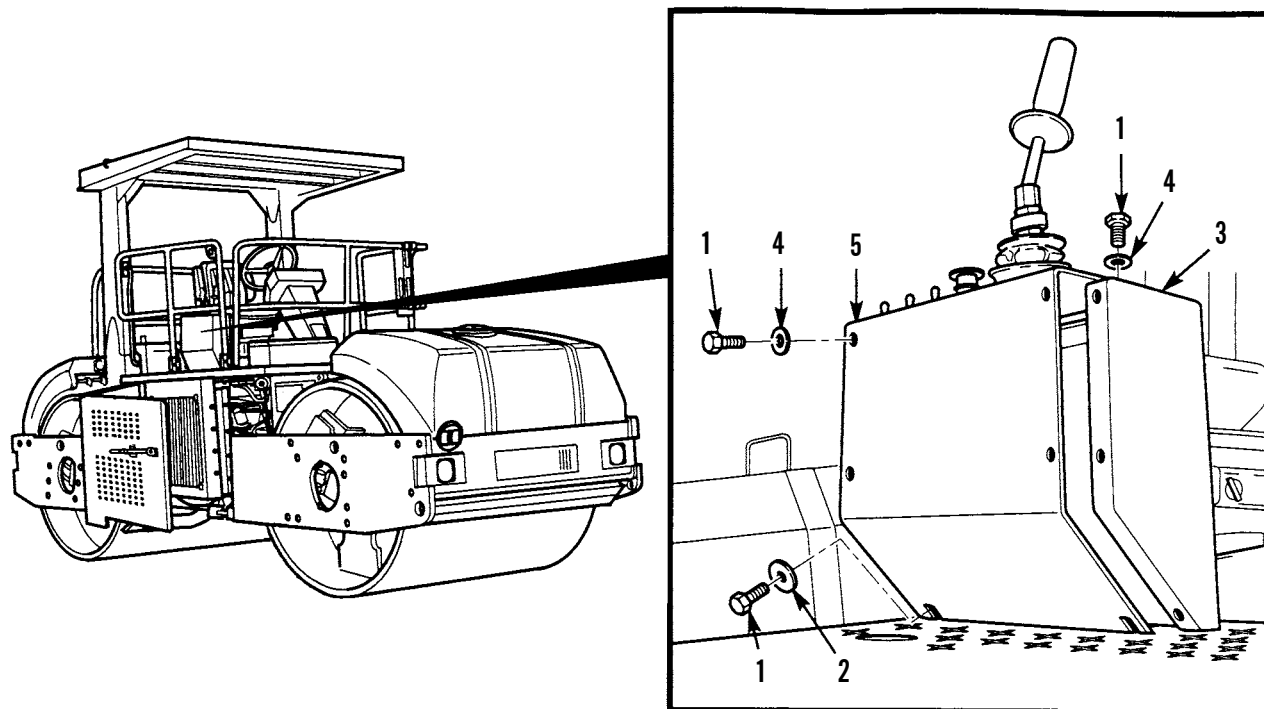

401-446

4. Close right-side door assembly (TM 5-3895-379-10).
5. Remove chocks (TM 5-3895-379-10).

END OF WORK PACKAGE

WORK LIGHT CONTROL SWITCH REPLACEMENT

0075 00**THIS WORK PACKAGE COVERS**

Removal, Installation

INITIAL SETUP**Tools and Special Tools**

Tool kit, general mechanic's (Item 36, WP 0220 00)

Materials/Parts

Strap, tiedown (Item 36, WP 0219 00)

Lockwasher (2)

References

TM 5-3895-379-23P, Figure 51

Equipment Condition

Engine off (TM 5-3895-379-10)

Drums chocked (TM 5-3895-379-10)

Battery disconnect switch in OFF position (TM 5-3895-379-10)

Right-side door assembly opened (TM 5-3895-379-10)

REMOVAL

1. Remove two screws (1) and washers (2) from operator station (3).
2. Remove seven screws (1) and washers (4) from operator station (3).
3. Lift panel assembly (5) and pull away from operator station (3).

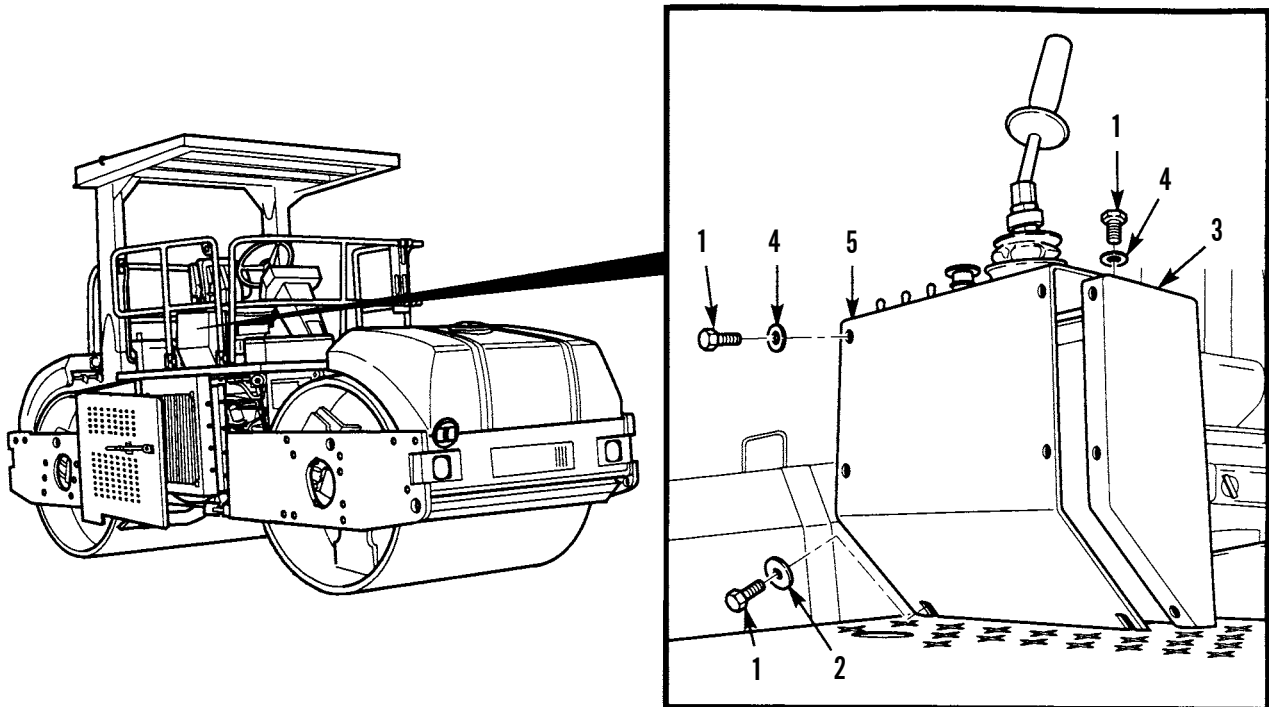

401-446

WORK LIGHT CONTROL SWITCH REPLACEMENT - CONTINUED**0075 00****INSTALLATION - CONTINUED**

5. Install panel assembly (5) on operator station (3) with two washers (2), seven washers (4) and nine screws (1).

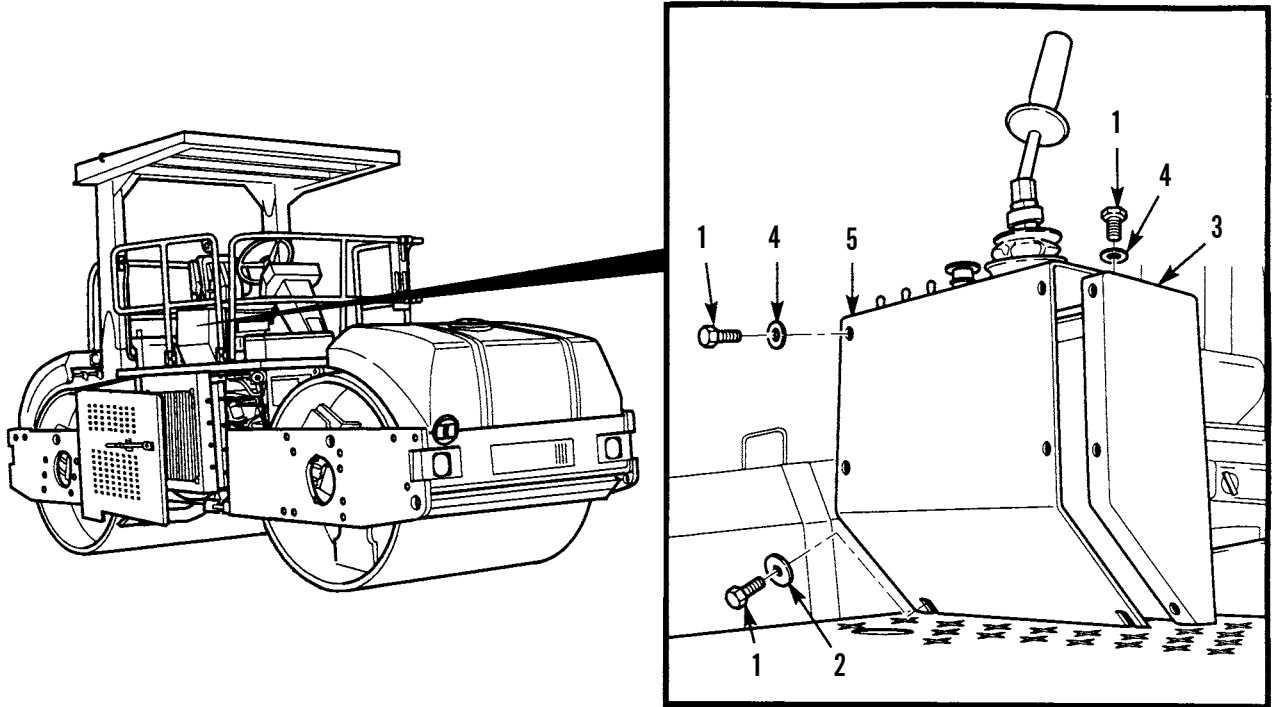

401-446

6. Close right-side door assembly (TM 5-3895-379-10).
7. Remove chocks (TM 5-3895-379-10).

END OF WORK PACKAGE

INTERMITTENT WATER SPRAY TIMER REPLACEMENT**0076 00****THIS WORK PACKAGE COVERS**

Removal, Installation

INITIAL SETUP**Tools and Special Tools**

Tool kit, general mechanic's (Item 36, WP 0220 00)

Materials/Parts

Tag, marker (Item 37, WP 0219 00)

Locknut

References

TM 5-3895-379-23P, Figure 50

Equipment Condition

Engine off (TM 5-3895-379-10)

Drums chocked (TM 5-3895-379-10)

Battery disconnect switch in OFF position (TM 5-3895-379-10)

Right-side door assembly opened (TM 5-3895-379-10)

REMOVAL

1. Remove two screws (1) and washers (2) from operator station (3).
2. Remove seven screws (1) and washers (4) from operator station (3).
3. Lift panel assembly (5) and pull away from operator station (3).

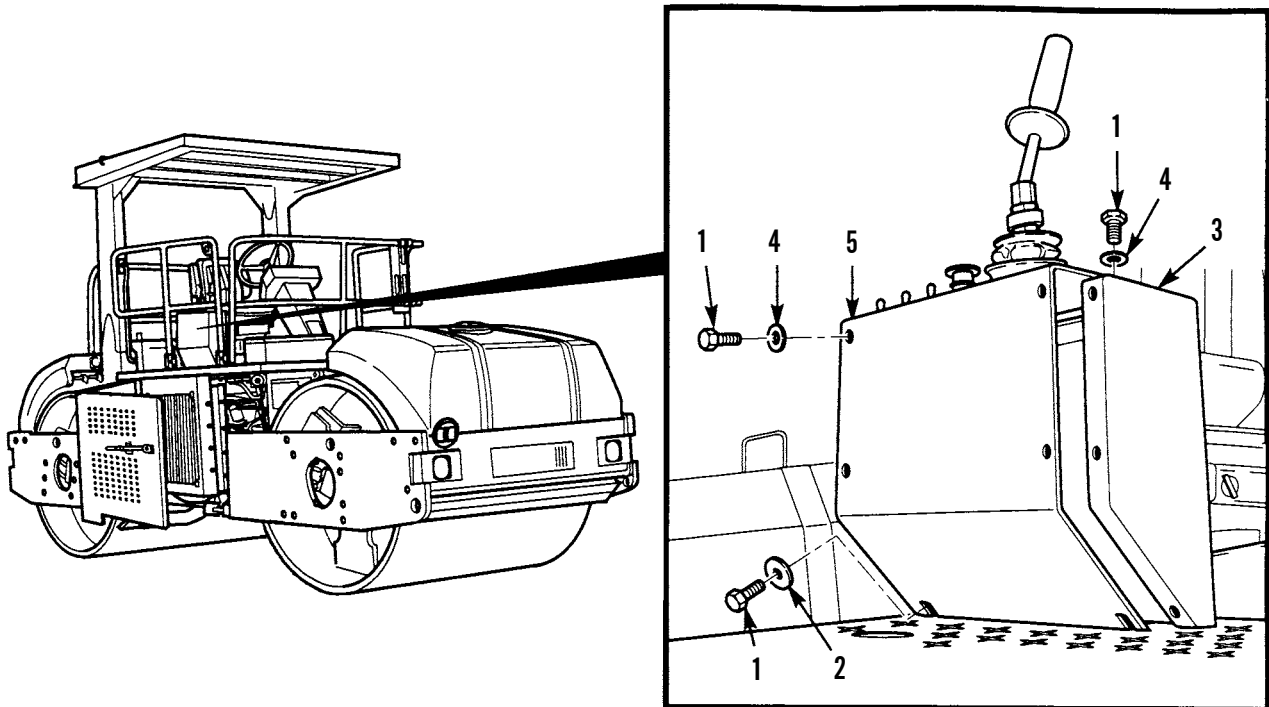

401-446

INTERMITTENT WATER SPRAY TIMER REPLACEMENT - CONTINUED**0076 00****REMOVAL****NOTE**

Tag and mark all wires prior to removal.

4. Remove three wires (6), (7) and (8) from timer (9).
5. Remove locknut (10), washer (11) and timer (9) from operator station (3). Discard locknut.

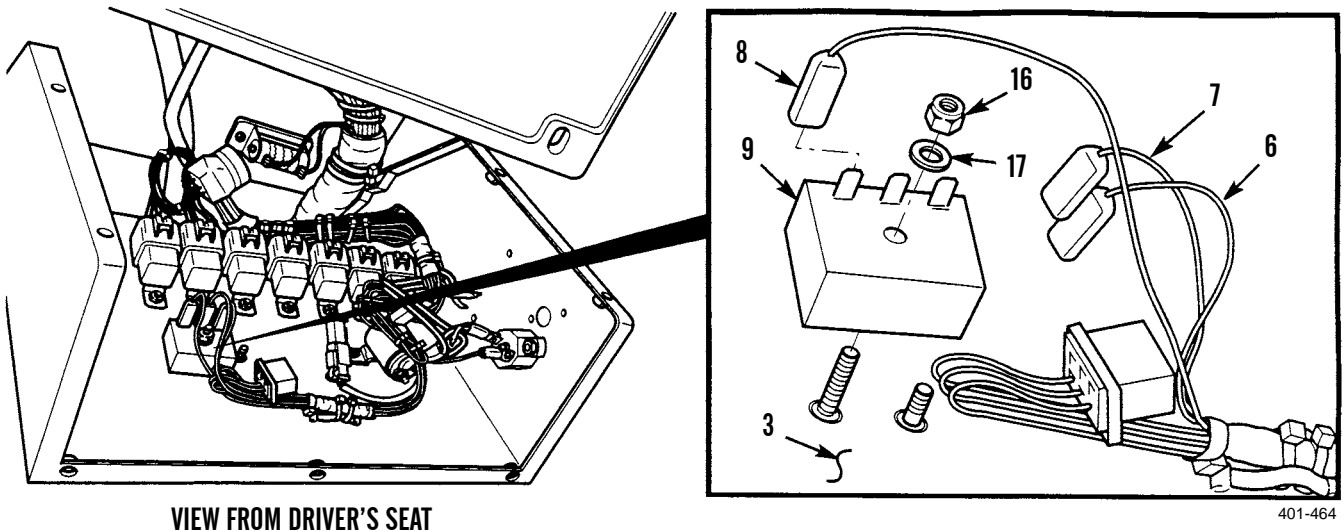
**INSTALLATION**

1. Install timer (9) on operator station (3) with washer (11) and new locknut (10). Tighten locknut.
2. Install three wires (6), (7) and (8) on timer (9).

INTERMITTENT WATER SPRAY TIMER REPLACEMENT - CONTINUED**0076 00****INSTALLATION**

3. Install panel assembly (5) on operator station (3) with two washers (2), seven washers (4) and nine screws (1).

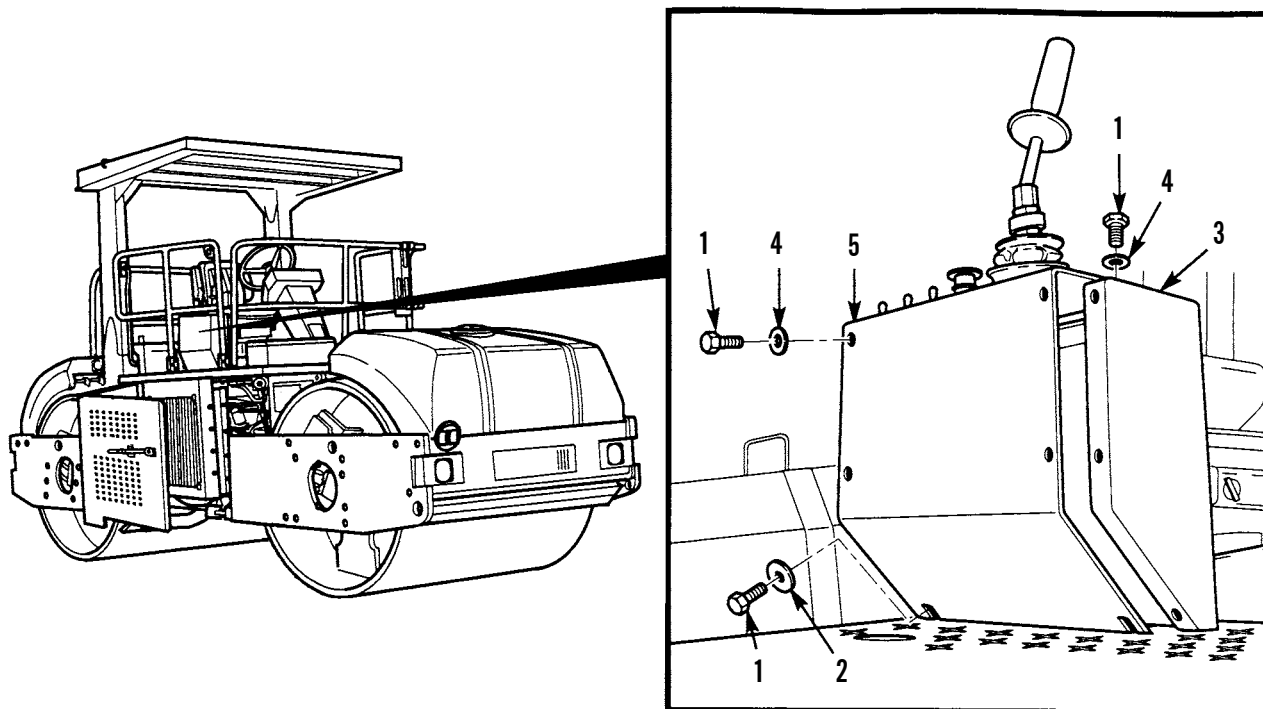

401-446

4. Close right-side door assembly (TM 5-3895-379-10).
5. Remove chocks (TM 5-3895-379-10).

END OF WORK PACKAGE

FUSE AND FUSE HOLDER REPLACEMENT

0077 00

THIS WORK PACKAGE COVERS

Removal, Installation

INITIAL SETUP**Tools and Special Tools**

Tool kit, general mechanic's (Item 36, WP 0220 00)

Materials/Parts

Solder (Item 35, WP 0219 00)

Tag, marker (Item 37, WP 0219 00)

Seal (2)

References

TM 5-3895-379-23P, Figure 48

Equipment Condition

Engine off (TM 5-3895-379-10)

Drums chocked (TM 5-3895-379-10)

Battery disconnect switch in OFF position (TM 5-3895-379-10)

Right-side door assembly opened (TM 5-3895-379-10)

REMOVAL**NOTE**

All fuse and fuse holders are replaced the same way. One fuse and fuse holder is shown.

1. Remove fuse holder assembly cap (1) from fuse holder assembly (2).
2. Remove fuse (3) and seal (4) from fuse holder assembly (1). Discard seal.

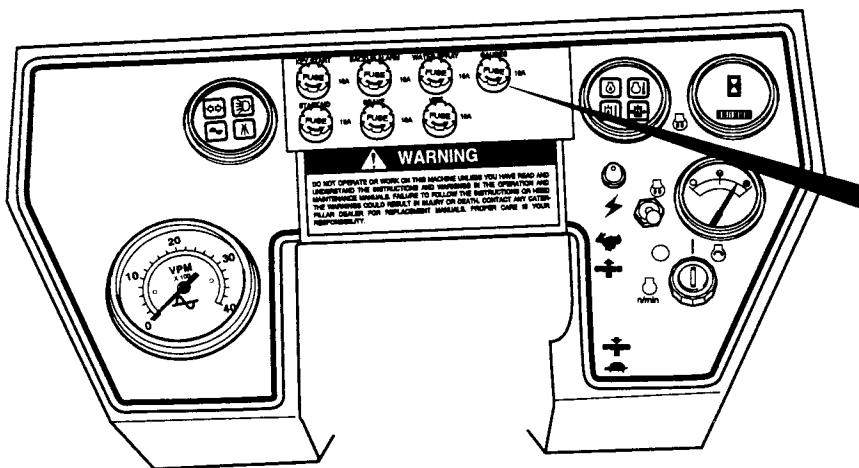

STEERING WHEEL SHOWN REMOVED FOR CLARITY

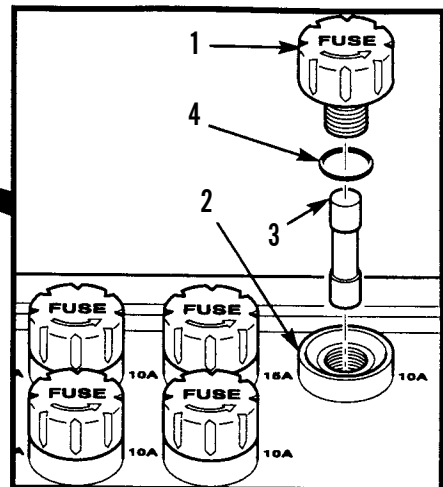

401-466

FUSE AND FUSE HOLDER REPLACEMENT - CONTINUED**0077 00****REMOVAL - CONTINUED**

3. Remove two shoulder screws (5), washers (6) and vandal guard (7) from instrument box assembly (8).
4. Remove three screws (9) and washers (10) from operator station (11).
5. Lift and tilt back instrument box assembly (8) to gain access to back of instrument box assembly.

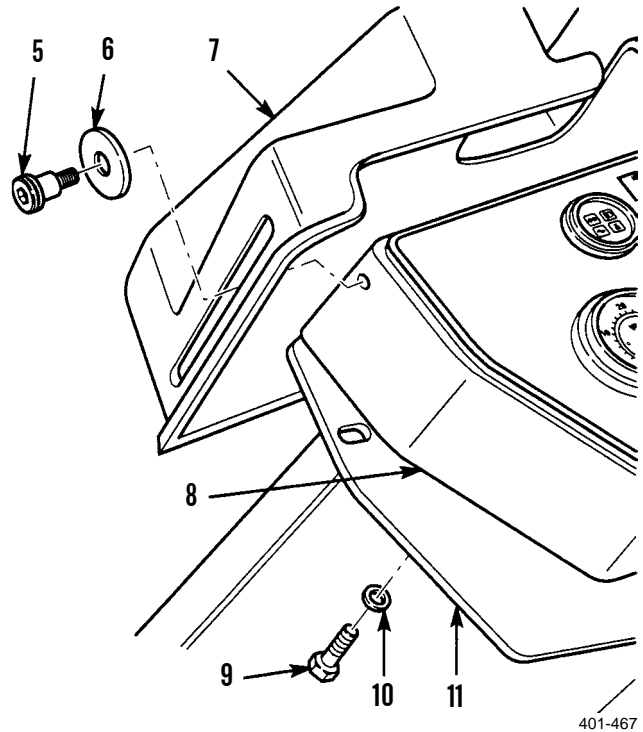
**NOTE**

Tag and mark all wires prior to removal.

6. Cut two wires (12) and remove from fuse holder assembly (2).
7. Remove nut (13) from fuse holder assembly (2).
8. Remove fuse holder assembly (2) and seal (14) from instrument box assembly (8). Discard seal.

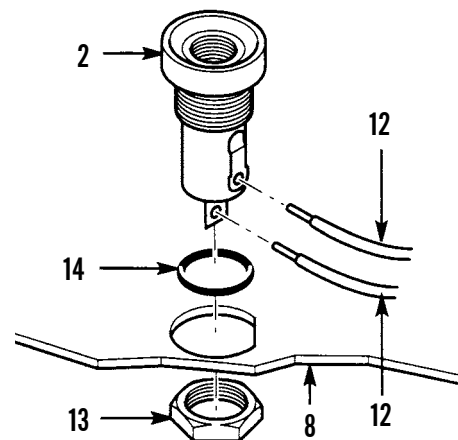
**INSTALLATION**

1. Install new seal (14) on fuse holder assembly (2).
2. Install fuse holder assembly (2) on instrument box assembly (8) with nut (13).

FUSE AND FUSE HOLDER REPLACEMENT - CONTINUED**0077 00****INSTALLATION - CONTINUED**

3. Solder two wires (12) on fuse holder assembly (2).
4. Install instrument box assembly (8) on operator station (11) with three washers (10) and screws (9).
5. Install vandal guard (7) on instrument box assembly (8) with two washers (6) and shoulder screws (5).
6. Install new seal (4) and fuse (3) in fuse holder assembly cap (1).
7. Install fuse holder assembly cap (1) on fuse holder assembly (2).

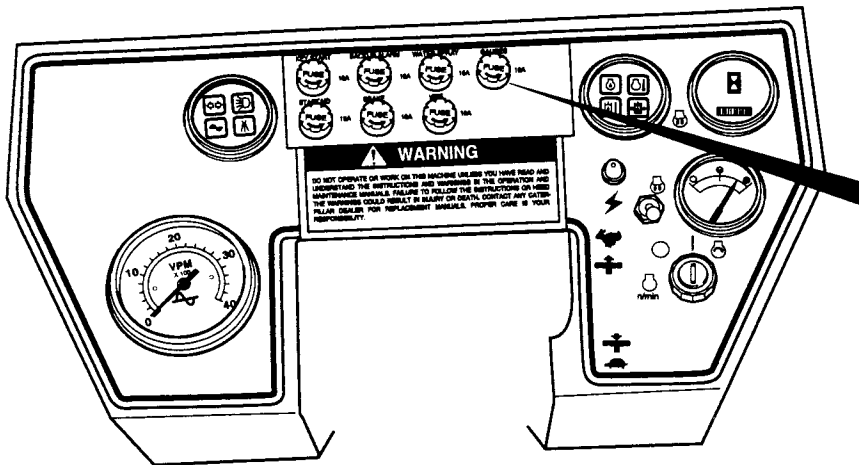
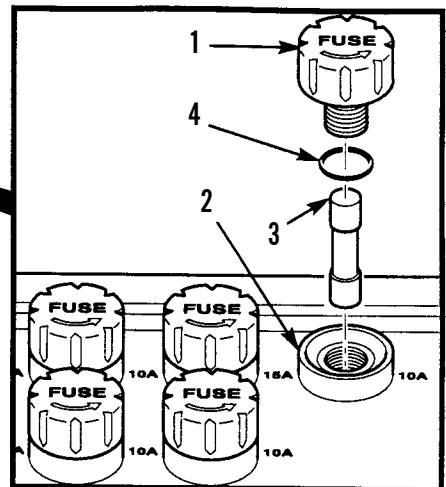
**STEERING WHEEL SHOWN REMOVED FOR CLARITY**

401-466

8. Close right-side door assembly (TM 5-3895-379-10).
9. Remove chocks (TM 5-3895-379-10).

END OF WORK PACKAGE

STARTING AID SWITCH REPLACEMENT**0078 00****THIS WORK PACKAGE COVERS**

Removal, Installation

INITIAL SETUP**Tools and Special Tools**

Tool kit, general mechanic's (Item 36, WP 0220 00)

Materials/Parts

Tag, marker (Item 37, WP 0219 00)

Lockwasher (3)

References

TM 5-3895-379-23P, Figure 49

Equipment Condition

Engine off (TM 5-3895-379-10)

Drums chocked (TM 5-3895-379-10)

Battery disconnect switch in OFF position (TM 5-3895-379-10)

Right-side door assembly opened (TM 5-3895-379-10)

REMOVAL

1. Remove two shoulder screws (1), washers (2) and vandal guard (3) from instrument box assembly (4).
2. Remove three screws (5) and washers (6) from operator station (7).
3. Lift and tilt back instrument box assembly (4) to gain access to back of instrument box assembly.

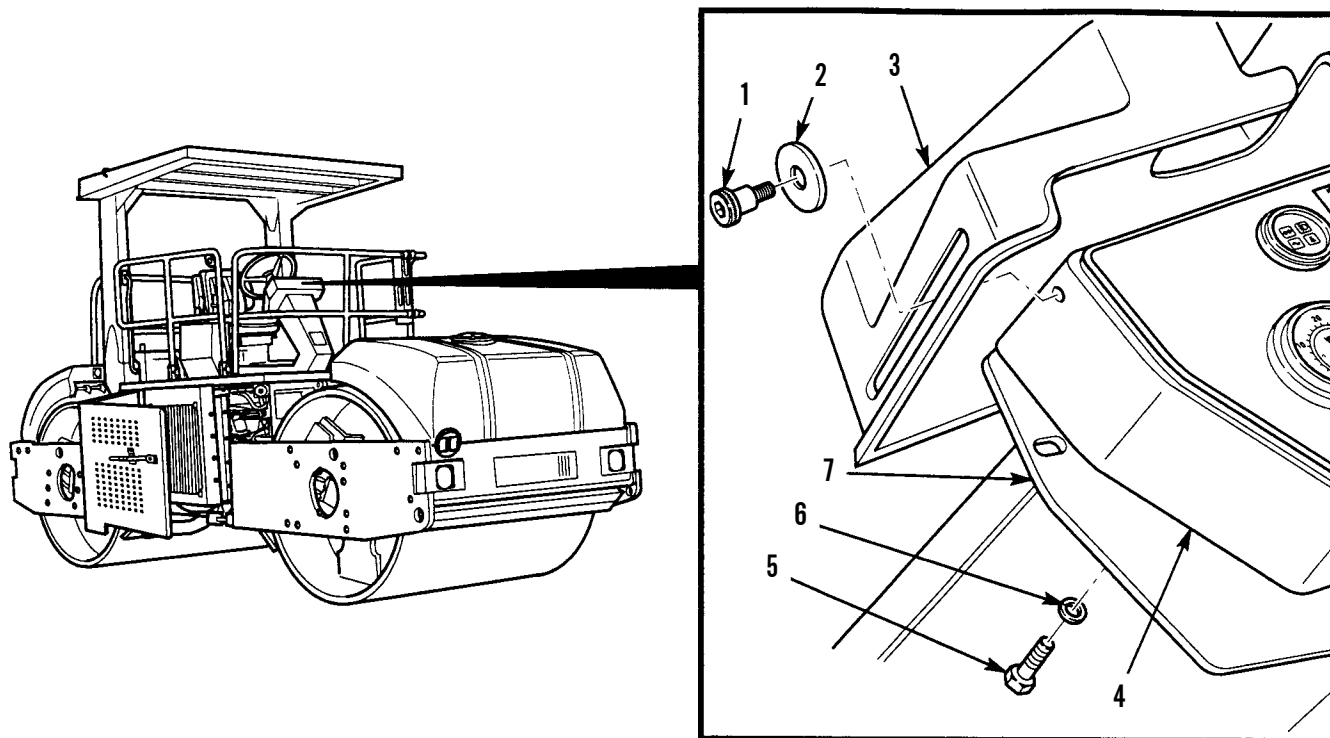

401-601

STARTING AID SWITCH REPLACEMENT - CONTINUED**0078 00****REMOVAL - CONTINUED****NOTE**

Tag and mark all wires prior to removal.

4. Remove two screws (8), wires (9) and lockwashers (10) from starting aid switch (11). Discard lockwasher.
5. Remove nut (12) and lockwasher (13) from starting aid switch (11). Discard lockwasher.
6. Remove starting aid switch (11) and ring (14) from instrument box assembly (4).
7. Remove locking ring (14) from starting aid switch (11).

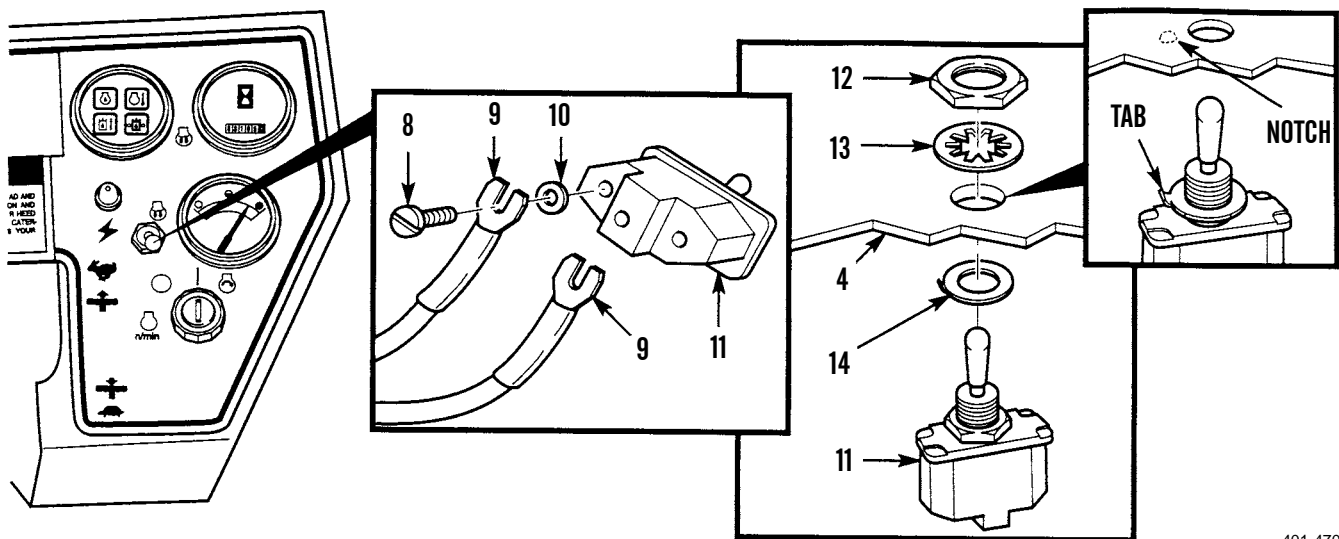

401-470

INSTALLATION**NOTE**

Tab or ring fits in notch of instrument box assembly to properly align starting aid switch.

1. Position ring (14) on starting aid switch (11).
2. Position ring (14) and starting aid switch (11) on instrument box assembly (4).
3. Install new lockwasher (13) and nut (12) on starting aid switch (11).
4. Install two new lockwashers (10) and wires (9) on starting aid switch (11) with screws (8).

STARTING AID SWITCH REPLACEMENT - CONTINUED**0078 00****INSTALLATION - CONTINUED**

5. Install instrument box assembly (4) on operator station (7) with three washers (6) and screws (5).
6. Install vandal guard (3) on instrument box assembly (4) with two washers (2) and shoulder screws (1).

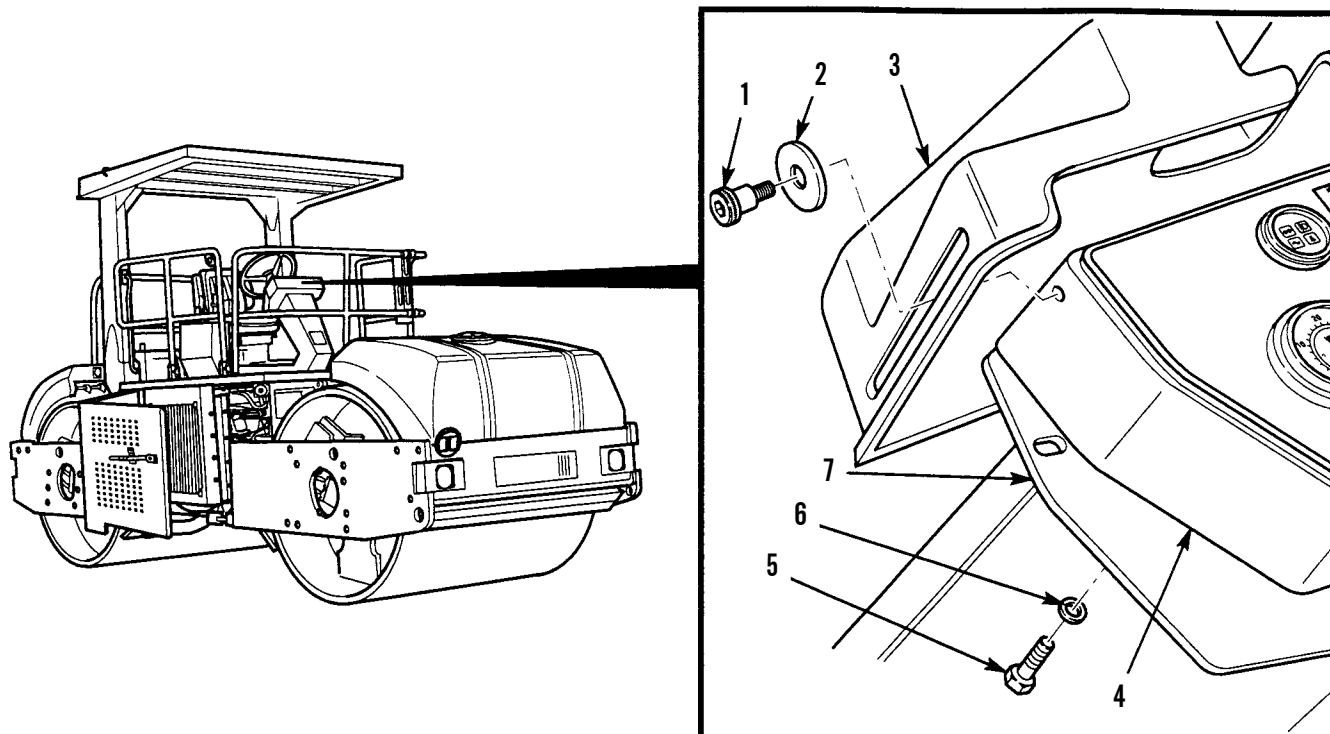

401-601

7. Close right-side door assembly (TM 5-3895-379-10).
8. Remove chocks (TM 5-3895-379-10).

END OF WORK PACKAGE

ENGINE START SWITCH REPLACEMENT**0079 00****THIS WORK PACKAGE COVERS**

Removal, Installation

INITIAL SETUP**Tools and Special Tools**

Tool kit, general mechanic's (Item 36, WP 0220 00)

Materials/Parts

Tag, marker (Item 37, WP 0219 00)

Lockwasher (3)

References

TM 5-3895-379-23P, Figure 48

Equipment Condition

Engine off (TM 5-3895-379-10)

Drums chocked (TM 5-3895-379-10)

Battery disconnect switch in OFF position (TM 5-3895-379-10)

Right-side door assembly opened (TM 5-3895-379-10)

REMOVAL

1. Remove two shoulder screws (1), washers (2) and vandal guard (3) from instrument box assembly (4).
2. Remove three screws (5) and washers (6) from operator station (7).
3. Lift and tilt back instrument box assembly (4) to gain access to back of instrument box assembly.

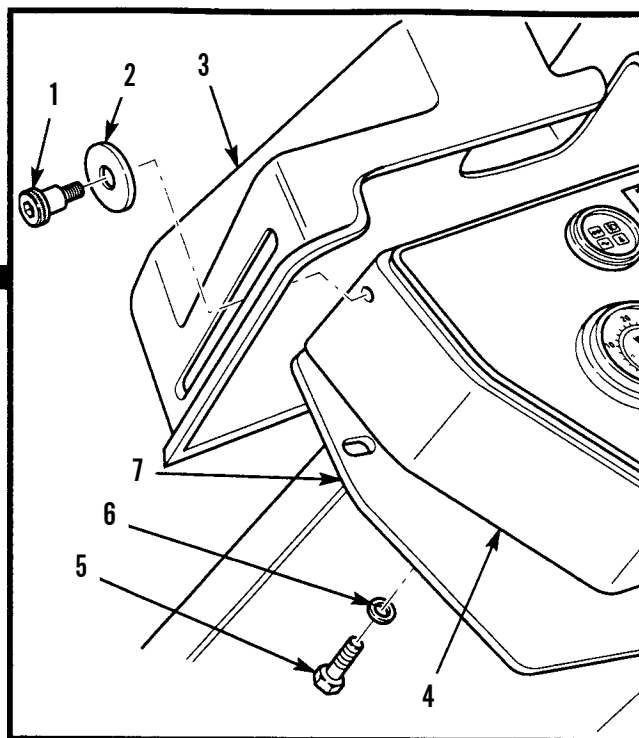
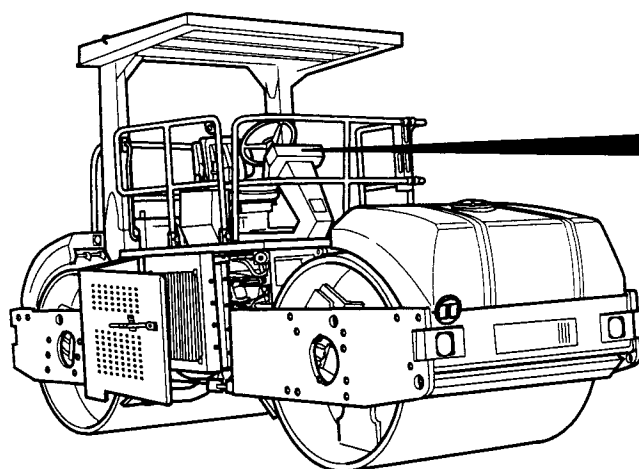

401-601

ENGINE START SWITCH REPLACEMENT - CONTINUED

0079 00

REMOVAL - CONTINUED

4. Remove nut (8) from lock assembly (9).
5. Remove lock assembly (9) from instrument box assembly (4).

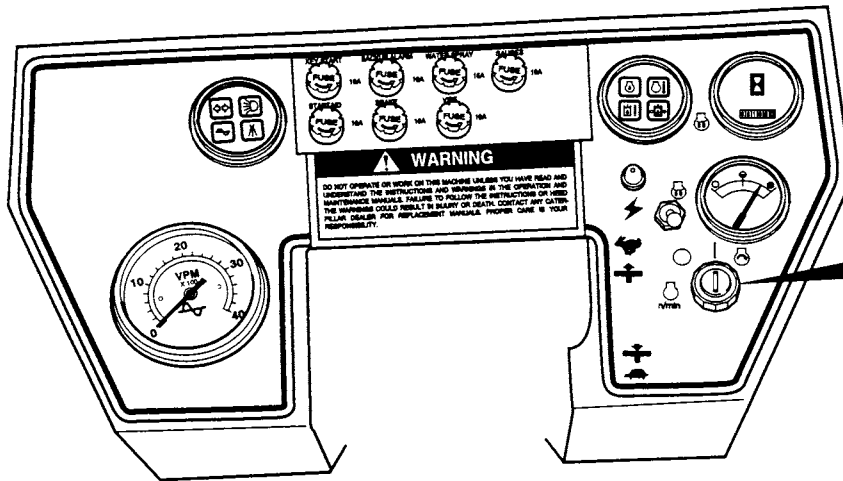
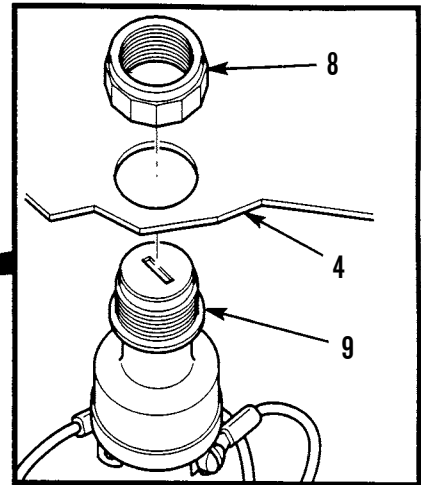
**STEERING WHEEL SHOWN REMOVED FOR CLARITY**

401-472

NOTE

Tag and mark all wires prior to removal.

6. Remove screw (10), wire (11) and lockwasher (12) from START terminal (13). Discard lockwasher.
7. Remove screw (14), wire (15) and lockwasher (16) from BATTERY terminal (17). Discard lockwasher.
8. Remove screw (18), wire (19) and lockwasher (20) from RELAY terminal (21). Discard lockwasher.

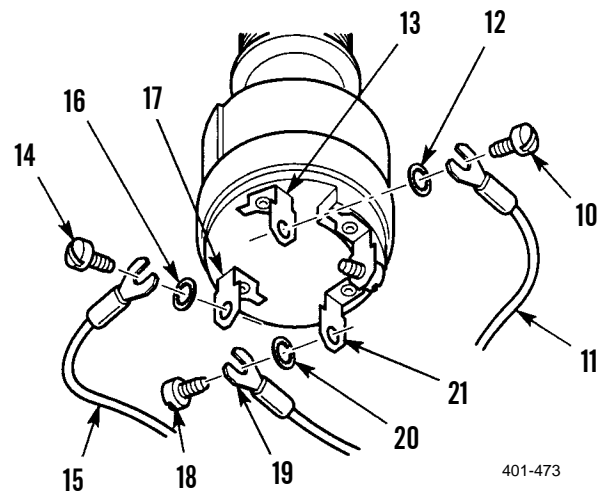

401-473

INSTALLATION

1. Install new lockwasher (20) and wire (19) on RELAY terminal (21) with screw (18).
2. Install new lockwasher (16) and wire (15) on BATTERY terminal (17) with screw (14).
3. Install new lockwasher (12) and wire (11) on START terminal (13) with screw (10).

NOTE

Tab of starter switch fits in notch of instrument box assembly to properly align starter switch in instrument box assembly.

4. Position lock assembly (9) in instrument box assembly (4).
5. Install nut (8) on lock assembly (9).

ENGINE START SWITCH REPLACEMENT - CONTINUED**0079 00****INSTALLATION - CONTINUED**

6. Install instrument box assembly (4) on operator station (7) with three washers (6) and screws (5).
7. Install vandal guard (3) on instrument box assembly (4) with two washers (2) and shoulder screws (1).

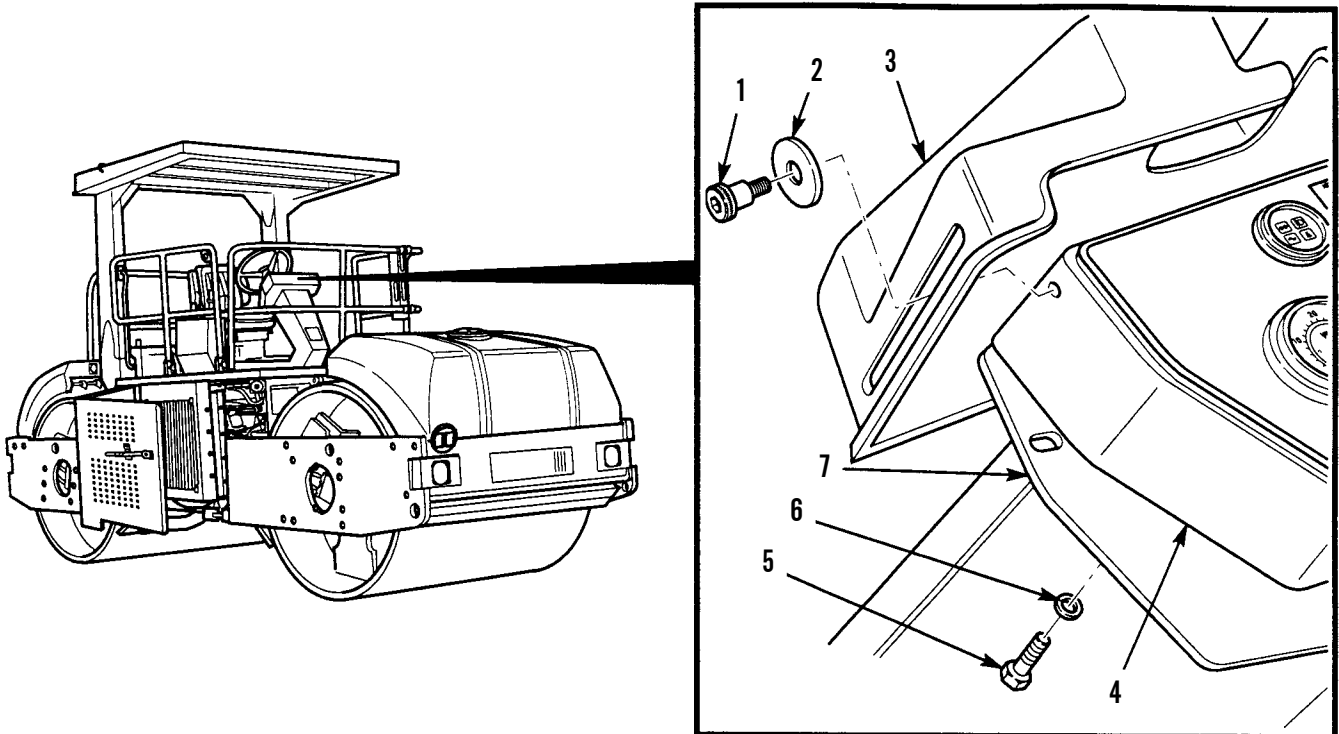

401-601

8. Close right-side door assembly (TM 5-3895-379-10).
9. Remove chocks (TM 5-3895-379-10).

END OF WORK PACKAGE

VIBRATION PUSH SWITCH REPLACEMENT**0080 00****THIS WORK PACKAGE COVERS**

Removal, Installation

INITIAL SETUP**Tools and Special Tools**

Tool kit, general mechanic's (Item 36, WP 0220 00)

Materials/Parts

Gasket (2)

Packing, preformed

References

TM 5-3895-379-23P, Figure 78

Equipment Condition

Engine off (TM 5-3895-379-10)

Drums chocked (TM 5-3895-379-10)

Battery disconnect switch in OFF position (TM 5-3895-379-10)

REMOVAL

1. Remove retainer ring (1) and cap (2) from grip housing (3) and (4).

CAUTION

Do not turn handle more than one full turn. Handle cannot be removed by unscrewing and should not be forced or turned more than needed to allow access to screws and nuts.

2. Loosen grip housings (3) and (4) on handle pipe (5) by turning grip housings counterclockwise not more than one full turn.

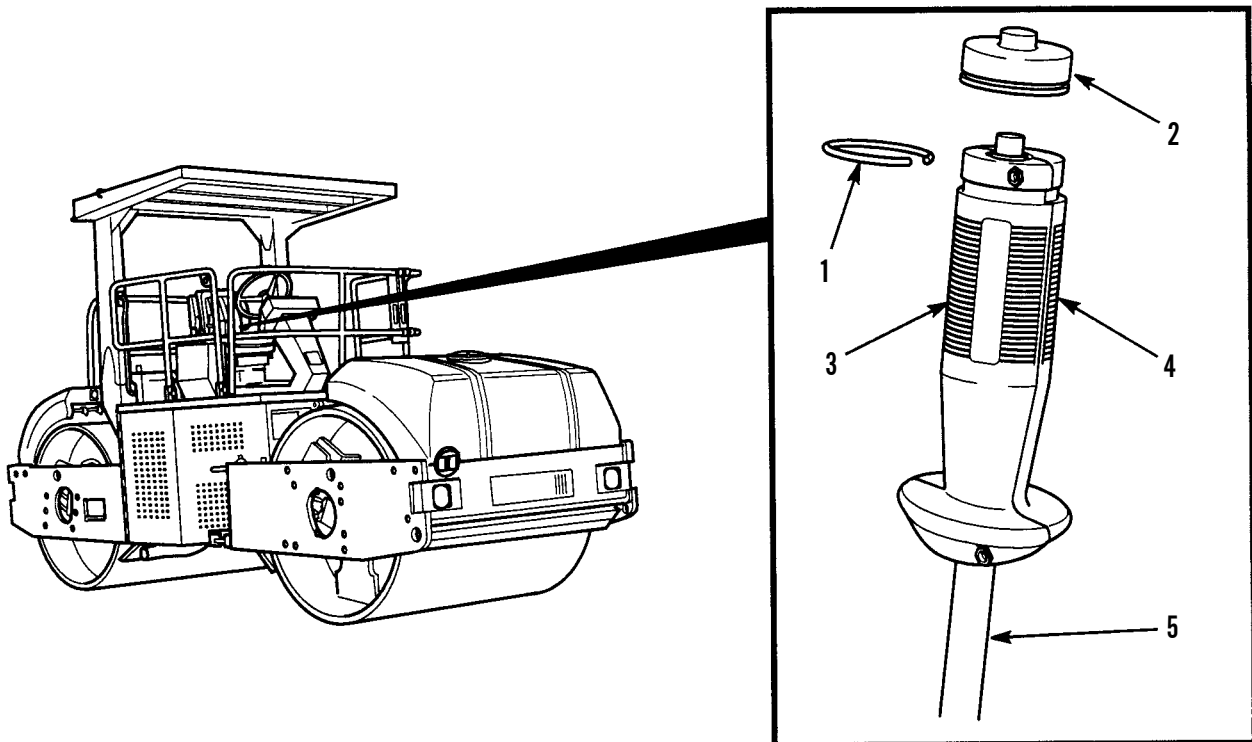

401-474

VIBRATION PUSH SWITCH REPLACEMENT - CONTINUED**0080 00****REMOVAL - CONTINUED****NOTE**

- Nuts are small and easily lost. Take extra care to not lose nuts.
- Nuts may stay with grip housing.

3. Remove two screws (6), four screws (7) and six nuts (8) from grip housings (3 and 4).
4. Remove two grip housing (3 and 4) from handle pipe (5) and vibration push switch (9).
5. Remove two gaskets (10) from grip housing (4). Discard gaskets.
6. Remove two screws (11) and wires (12) from vibration push switch (9).
7. Remove nut (13) and preformed packing (14) from handle pipe (5). Discard preformed packing.

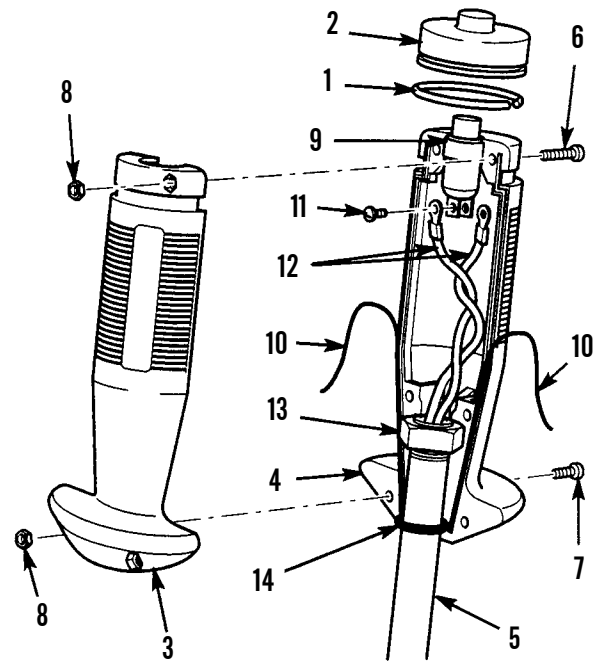

401-475

INSTALLATION

1. Install new preformed packing (14) and nut (13) on handle pipe (5). Turn nut onto handle pipe until top of nut is flush with top of handle pipe.
2. Install two wires (12) on vibration push switch (9) with two screws (11).
3. Install two new gaskets (10) in grip housing (4).

NOTE

- Grip housings will not fit together if any threads of handle pipe are showing on top side of nut while nut is installed.
- Mate flat sides of nut with cavity on grip housing.

4. Install grip housing (4) on handle pipe (5), nut (13) and new preformed packing (14).
5. Install vibration push switch (9) in grip housing (4).
6. Install grip housing (3) on grip housing (4) with two screws (6), four screws (7) and six nuts (8).
7. Tighten grip housings (3) and (4) on handle pipe (5) by turning grip housings to right until snug. Do not over-tighten.



Download the full PDF manual instantly.

Our customer service e-mail:

aservicemanualpdf@yahoo.com