

RB545 Silage Pack Round baler

SERVICE MANUAL

Part number 48126528

English

April 2017

© 2017 CNH Industrial Belgium N.V. All Rights Reserved.





SERVICE MANUAL

RB545 SP Silage Pack

Contents

INTRODUCTION

Power Take-Off (PTO)	31
[31.220] Gearbox	31.1
Hydraulic systems.....	35
[35.000] Hydraulic systems.....	35.1
[35.204] Remote control valves	35.2
[35.550] Tailgate circuit	35.3
[35.599] Combi hydraulic system.....	35.4
Frames and ballasting	39
[39.100] Frame	39.1
Electrical systems	55
[55.000] Electrical system	55.1
[55.100] Harnesses and connectors.....	55.2
[55.640] Electronic modules.....	55.3
[55.DTC] FAULT CODES.....	55.4
Product feeding	60
[60.220] Pickup	60.1
[60.260] Rotor	60.2
Pressing - Bale formation.....	62
[62.140] Bale formation.....	62.1
Tying/Wrapping/Twisting	68
[68.200] Net and plastic wrapper	68.1
Ejection	70
[70.280] Bale ejector components.....	70.1
[70.270] Combi frame and main parts	70.2

Platform, cab, bodywork, and decals 90
[90.105] Machine shields and guards 90.1



INTRODUCTION

Safety rules

RB545 SP

Personal safety





This is the safety alert symbol. It is used to alert you to potential personal injury hazards. Obey all safety messages that follow this symbol to avoid possible death or injury.

Throughout this manual you will find the signal words DANGER, WARNING, and CAUTION followed by special instructions. These precautions are intended for the personal safety of you and those working with you.

Read and understand all the safety messages in this manual before you operate or service the machine.

 DANGER indicates a hazardous situation that, if not avoided, will result in death or serious injury.

 WARNING indicates a hazardous situation that, if not avoided, could result in death or serious injury.

 CAUTION indicates a hazardous situation that, if not avoided, could result in minor or moderate injury.

FAILURE TO FOLLOW DANGER, WARNING, AND CAUTION MESSAGES COULD RESULT IN DEATH OR SERIOUS INJURY.

Machine safety

NOTICE: Notice indicates a situation that, if not avoided, could result in machine or property damage.

Throughout this manual you will find the signal word Notice followed by special instructions to prevent machine or property damage. The word Notice is used to address practices not related to personal safety.

Information

NOTE: Note indicates additional information that clarifies steps, procedures, or other information in this manual.

Throughout this manual you will find the word Note followed by additional information about a step, procedure, or other information in the manual. The word Note is not intended to address personal safety or property damage.

Safety rules - Ecology and the environment

Soil, air, and water quality is important for all industries and life in general. When legislation does not yet rule the treatment of some of the substances that advanced technology requires, sound judgment should govern the use and disposal of products of a chemical and petrochemical nature.

Familiarize yourself with the relative legislation applicable to your country, and make sure that you understand this legislation. Where no legislation exists, obtain information from suppliers of oils, filters, batteries, fuels, anti-freeze, cleaning agents, etc., with regard to the effect of these substances on man and nature and how to safely store, use, and dispose of these substances.

Helpful hints

- Avoid the use of cans or other inappropriate pressurized fuel delivery systems to fill tanks. Such delivery systems may cause considerable spillage.
- In general, avoid skin contact with all fuels, oils, acids, solvents, etc. Most of these products contain substances that may be harmful to your health.
- Modern oils contain additives. Do not burn contaminated fuels and or waste oils in ordinary heating systems.
- Avoid spillage when you drain fluids such as used engine coolant mixtures, engine oil, hydraulic fluid, brake fluid, etc. Do not mix drained brake fluids or fuels with lubricants. Store all drained fluids safely until you can dispose of the fluids in a proper way that complies with all local legislation and available resources.
- Do not allow coolant mixtures to get into the soil. Collect and dispose of coolant mixtures properly.
- The air-conditioning system contains gases that should not be released into the atmosphere. Consult an air-conditioning specialist or use a special extractor to recharge the system properly.
- Repair any leaks or defects in the engine cooling system or hydraulic system immediately.
- Do not increase the pressure in a pressurized circuit as this may lead to a component failure.
- Protect hoses during welding. Penetrating weld splatter may burn a hole or weaken hoses, allowing the loss of oils, coolant, etc.

Battery recycling

Batteries and electric accumulators contain several substances that can have a harmful effect on the environment if the batteries are not properly recycled after use. Improper disposal of batteries can contaminate the soil, groundwater, and waterways. CASE IH strongly recommends that you return all used batteries to a CASE IH dealer, who will dispose of the used batteries or recycle the used batteries properly. In some countries, this is a legal requirement.



Mandatory battery recycling

NOTE: *The following requirements are mandatory in Brazil.*

Batteries are made of lead plates and a sulfuric acid solution. Because batteries contain heavy metals such as lead, CONAMA Resolution 401/2008 requires you to return all used batteries to the battery dealer when you replace any batteries. Do not dispose of batteries in your household garbage.

Points of sale are obliged to:

- Accept the return of your used batteries
- Store the returned batteries in a suitable location
- Send the returned batteries to the battery manufacturer for recycling



SERVICE MANUAL

Power Take-Off (PTO)

RB545 SP Silage Pack

Contents

Power Take-Off (PTO) - 31

[31.220] Gearbox	31.1
------------------------	------



Power Take-Off (PTO) - 31

Gearbox - 220

RB545 SP Silage Pack

Contents

Power Take-Off (PTO) - 31

Gearbox - 220

SERVICE

Gearbox	
Remove	3
Install	6
Gearbox drive shaft	
Remove	8
Install	11

Gearbox - Remove

Prior operation:

Remove the net and plastic wrapper, see **Net and plastic wrapper - Remove (68.200)**.

1. Remove the Power Take-Off (PTO) shaft.

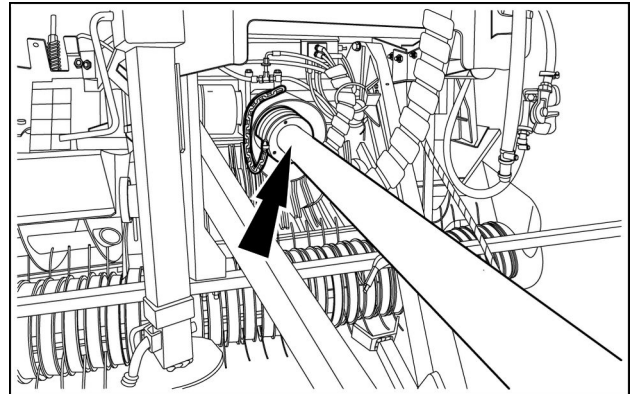

ZEIL16RB00567AA 1

2. Release the tension of the rotor/pickup main drive chain and the front/rear rollers main drive chain, see the operator's manual.

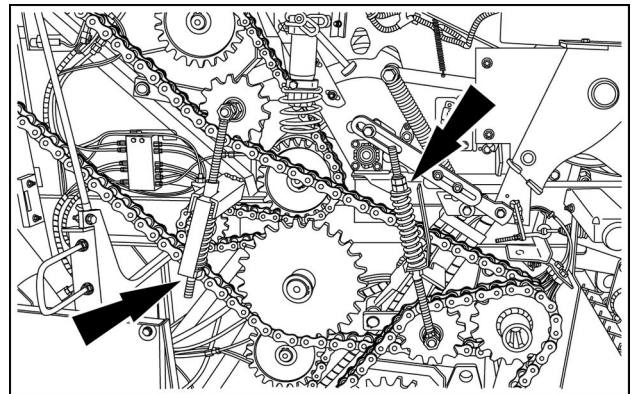

ZEIL16RB00105AA 2

3. Install the wrench (1) onto the output shaft of the gearbox.

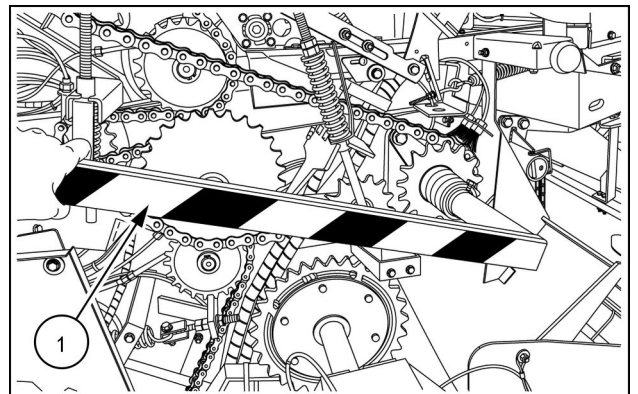

ZEIL16RB00039AA 3

4. Use the wrench to turn the shaft (2) to allow access to the connector link of the chain (3).
5. Remove the chain (3) from the sprocket on the gearbox (4) and the sprocket on the shaft (2).

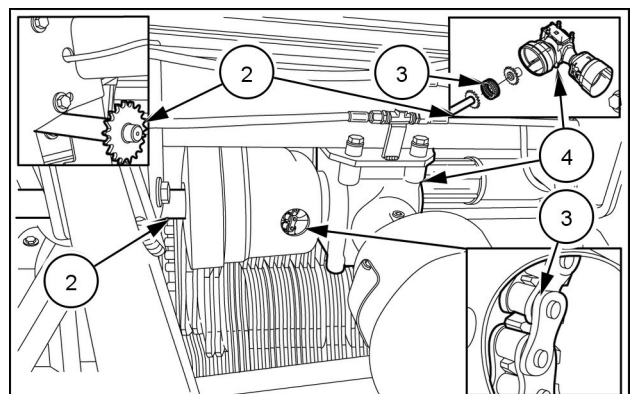

ZEIL13RB00002AB 4



Download the full PDF manual instantly.

Our customer service e-mail:

aservicemanualpdf@yahoo.com